

ALTAIR



28 Robin Boyd Crescent Taylor ACT

4 🛏 3 🚿 2 🚗

This luxurious 4-bedroom family home has been thoughtfully designed with multiple living areas & finished with incredible inclusions. Nestled on a 495m2 block, this property boasts 255m2 of built area, providing ample space for families of all sizes. Positioned next to a nature reserve, & within a stone's throw away from picturesque walking trails weaving through the neighbourhood, this home offers a tranquil lifestyle away from the hustle and bustle of the city.

The sophisticated design is evident from its street presence, adorned with a striking skillion roof, a combination of render, cladding, and large windows. The landscaped frontage guides you to a welcoming entrance portico, leaving a lasting first impression.

[For full version visit the website](https://www.altairproperty.com.au)

Type : House
Building Size : 255 sqm
Land Size : 495 sqm
View : <https://www.altairproperty.com.au/sale/act/gungahlin/taylor/residential/house/8201212>



Rahul Mehta
0404 895 162

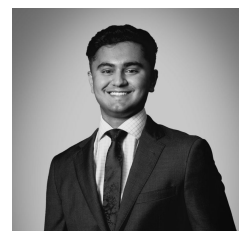

Arjun Choudhary
0404 895 162

<https://www.altairproperty.com.au>



FLOOR PLAN

PLANS SHOWN ARE FOR MARKETING PURPOSES ONLY. ALL DIMENSIONS ARE APPROXIMATE AND NOT TO SCALE. THEY ARE SUBJECT TO ERRORS AND INACCURACIES AND NO LIABILITY WILL BE ACCEPTED. INTERESTED PARTIES SHOULD MAKE THEIR OWN ENQUIRIES.



FLOOR PLAN

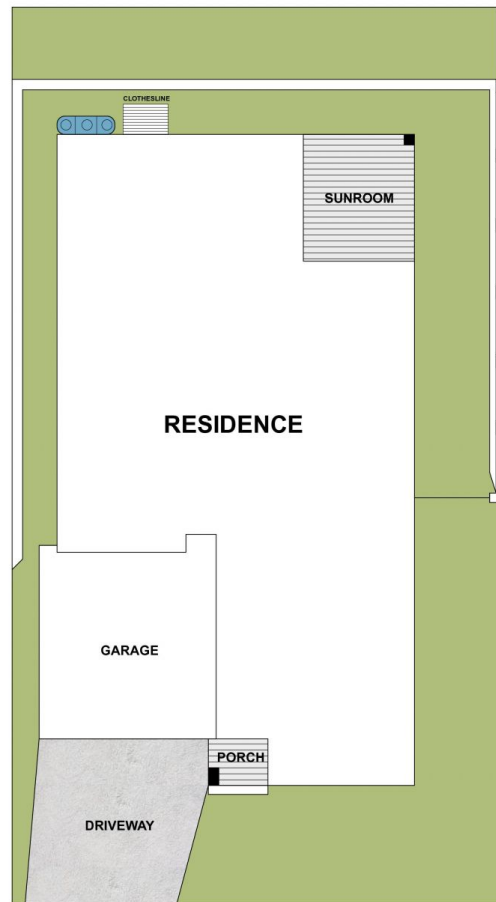

SITE PLAN

PLANS SHOWN ARE FOR MARKETING PURPOSES ONLY. ALL DIMENSIONS ARE APPROXIMATE AND NOT TO SCALE. THEY ARE SUBJECT TO ERRORS AND INACCURACIES AND NO LIABILITY WILL BE ACCEPTED. INTERESTED PARTIES SHOULD MAKE THEIR OWN ENQUIRIES.